

INSULATING SUPPORTS
FOR CONNECTIONS
AND TERMINALS
EXTENSION



Alcu[®]
SYSTEM

INSULATING SUPPORTS FOR CONNECTIONS AND TERMINALS EXTENSION

A complete range of insulating supports, stiffeners and hexagonal insulators specifically designed for busbar systems connections and terminals extension.

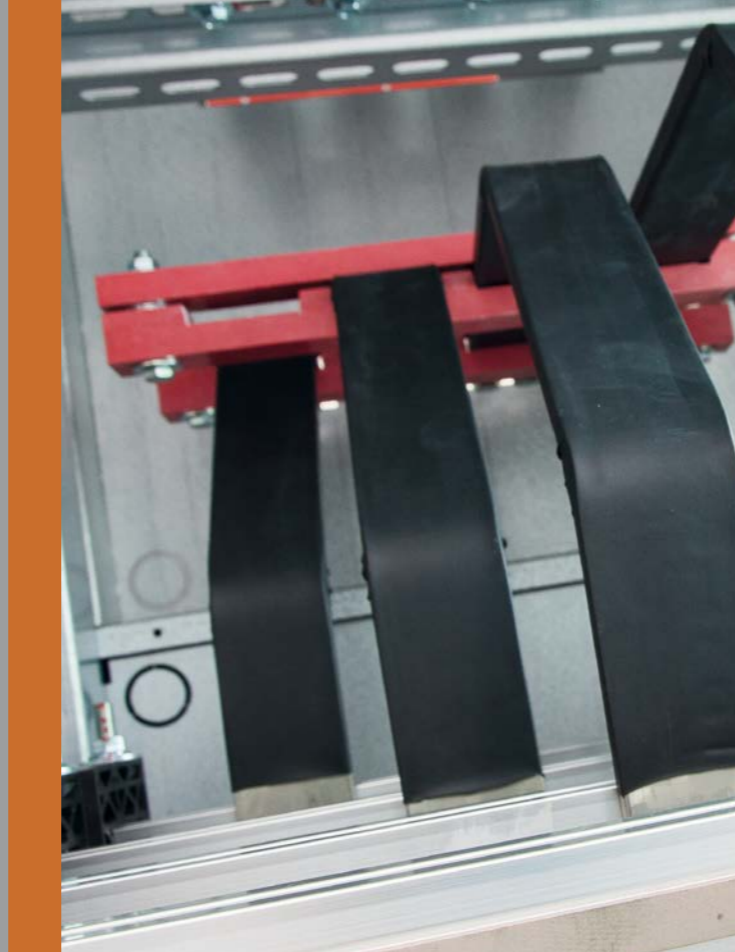

GPO-03 SHEET LAMINATES STIFFENERS

Insulating stiffeners for terminals connection and extension

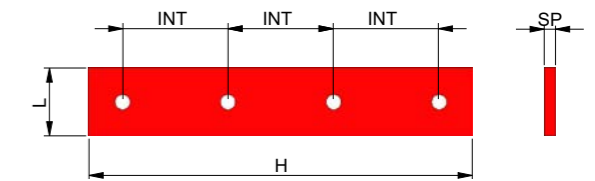
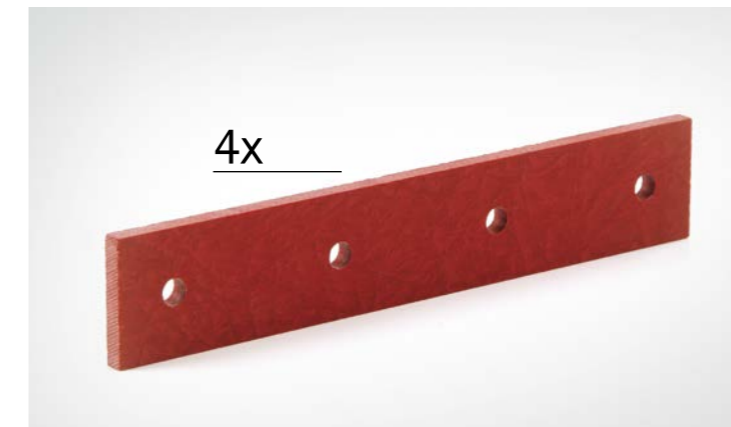

PRODUCT CODE	PACKAGE CONTENT	WEIGHT (KG)	L (MM)	SP THICKNESS (MM)	H HEIGHT (MM)	Ø HOLE (MM)	I (MM) CIRCUIT BREAKER POLE-CENTER DISTANCE
PG30A/C	4	0,12	30	5	110	6,5	30
PG35A/C	4	0,14	30	5	125	6,5	35
PG45A/C	4	0,14	30	5	165	6,5	45
PG46A/C	4	0,18	30	5	169.5	6,5	46.5
PG63A/C	4	0,5	30	10	230.5	9,2	63.5
PG70A/C	4	0,28	30	5	260	8	70
PG70/10A/C	4	0,56	30	10	260	8	70
PG76A/C	4	0,8	40	10	278	11,2	76
PG90A/C	4	0,76	40	10	330	11,2	90
PG115A/C	4	1,24	40	10	425	11,2	115
PG120A/C	4	1,37	40	10	470	11,2	120
PG126A/C	4	0,83	40	10	478	11,2	126
PG130A/C	4	1,61	40	15	490	11,2	130



The whole range of accessories is compatible with different types of circuit breakers to make wiring easier and quicker regardless of the brand of devices used.

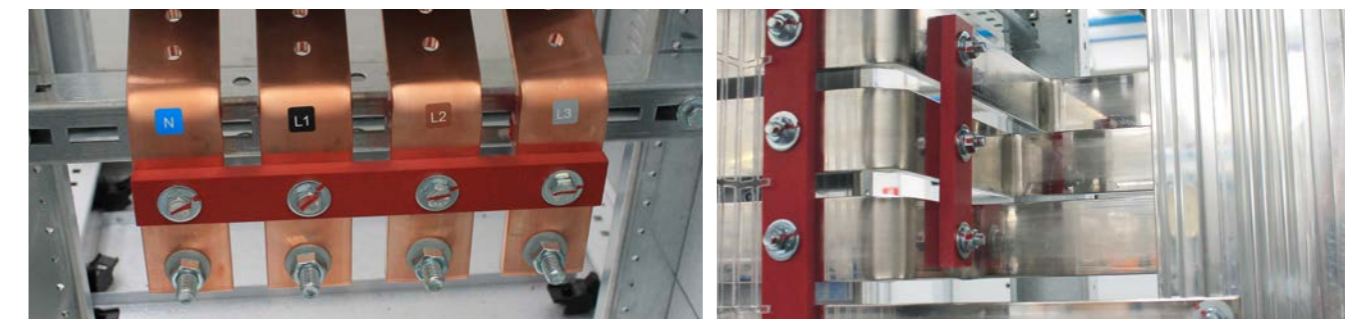

INSULATED BRACKETS

INSULATED BRACKETS

GPO-03 SHEET LAMINATES STIFFENERS (LENGTH 1700MM)

Insulating stiffeners length 1700 mm

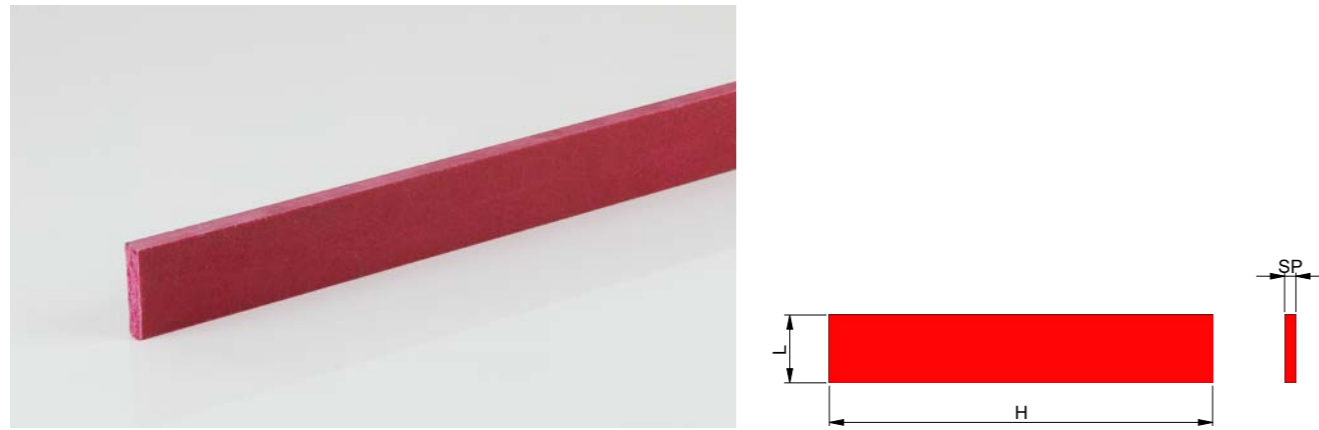

PRODUCT CODE	PACKAGE CONTENT	WEIGHT (KG)	L (MM)	SP - THICKNESS (MM)	H (MM)
GPO33010/C	4	1,2	30	10	1700
GPO33030/C	4	1,2	30	30	1700
GPO34010/C	4	1,2	40	10	1700
GPO34020/C	4	1,2	40	20	1700
GPO34030/C	4	1,2	40	30	1700
GPO3406/C	4	0,67	40	6	1700
GPO3408/C	4	0,9	40	8	1700

MILLED GPO-03 STIFFENERS

Kit including 02 Insulating milled GPO-03 stiffeners and 2 screws/ nuts

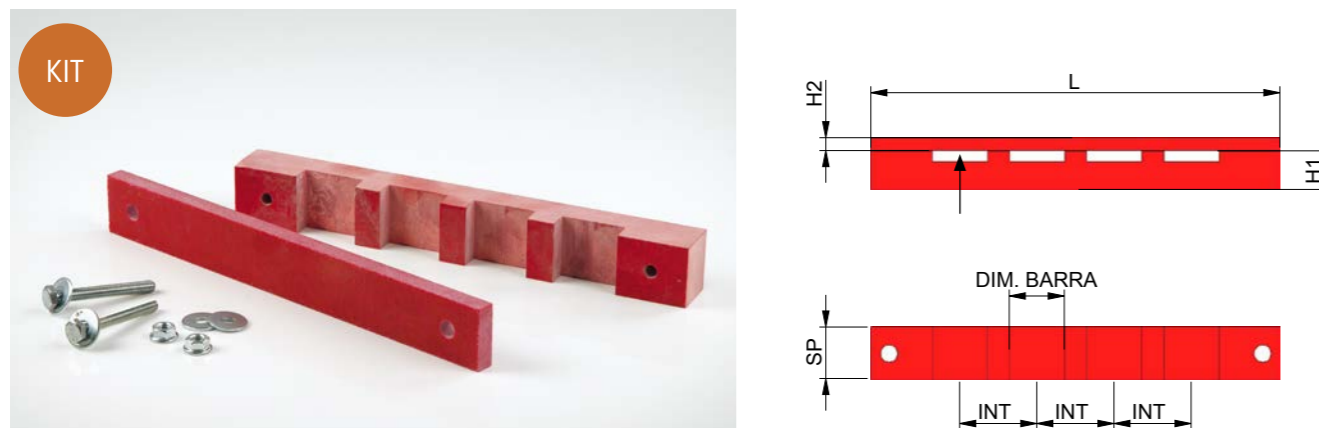

PRODUCT CODE	PACKAGE CONTENT	WEIGHT (KG)	L LENGTH (MM)	SP THK (MM)	CIRCUIT BREAKER POLE-CENTER DISTANCE (MM)	H1 (MM)	H2 (MM)	BAR DIM. (MM)
PS30P/C	1 kit	0,47	159	20	30	20	5	20x4
PS35P/C	1 kit	1	178	25	35	20	5	20x5
PS45P/C	1 kit	1,25	235	30	45	30	10	30x10
PS46P/C	1 kit	1,25	235	35	46	30	10	40x10
PS63P/C	1 kit	1,85	340	35	63	40	10	50x10
PS70P/C	1 kit	1,92	340	35	70	50	10	50x10
PS76P/C	1 kit	1,95	358	35	76	50	10	50x10

BRACKET FOR TERMINALS EXTENSION EQUIPPED WITH HEXAGONAL INSULATORS

Kit including 01 bracket equipped with 4 hexagonal insulators for circuit breaker terminals extension

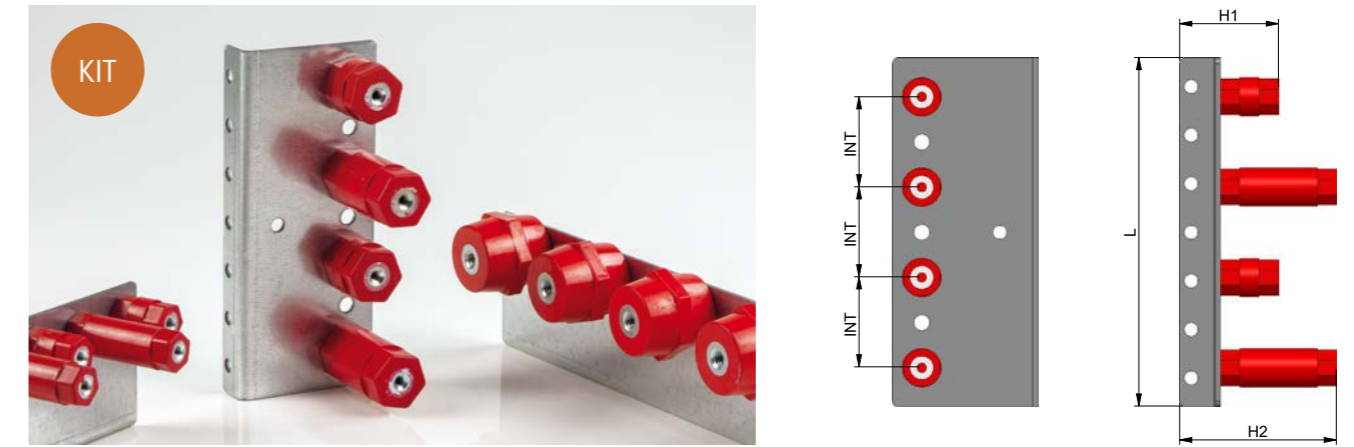

PRODUCT CODE	PACKAGE CONTENT	WEIGHT (KG)	L LENGTH (MM)	SP THK (MM)	CIRCUIT BREAKER POLE-CENTER DISTANCE (MM)	H1 (MM)	H2 (MM)	BAR DIM. (MM)
SC30P/C	1 kit	0,35	159	20	30	20	84	54
SC35P/C	1 kit	0,35	178	25	35	20	84	54
SC45P/C	1 kit	0,35	178	25	45	25	84	54
SC46P/C	1 kit	0,35	235	30	46	30	84	54
SC63P/C	1 kit	0,48	235	35	63	30	64	64
SC70P/C	1 kit	0,61	340	35	70	40	64	64
SC76P/C	1 kit	0,65	340	35	76	50	64	64

BRACKET FOR TERMINALS EXTENSION EQUIPPED WITH HEXAGONAL INSULATORS

Kit including 01 bracket equipped with 4 hexagonal insulators for circuit breaker terminals extension

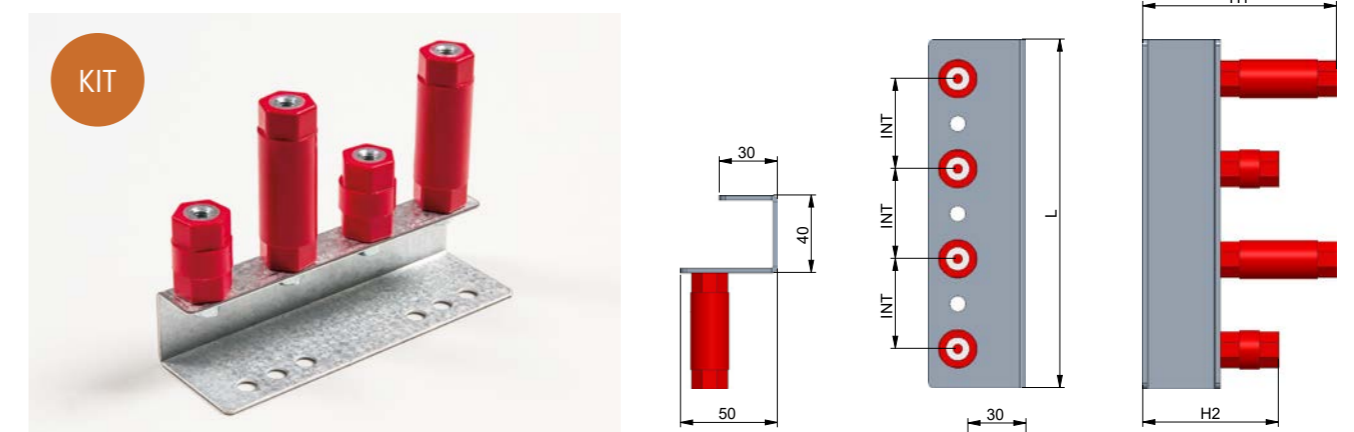

PRODUCT CODE	PACKAGE CONTENT	WEIGHT (KG)	L LENGTH (MM)	SP THK (MM)	CIRCUIT BREAKER POLE-CENTER DISTANCE (MM)	H1 (MM)	H2 (MM)	BAR DIM. (MM)
SC30C/C	1 kit	0,32	159	20	30	20	84	54
SC35C/C	1 kit	0,35	178	25	35	20	84	54
SC45C/C	1 kit	0,35	178	25	45	25	84	54
SC46C/C	1 kit	0,35	235	30	46	30	84	54
SC63C/C	1 kit	0,47	235	35	63	30	64	64
SC70C/C	1 kit	0,61	340	35	70	40	64	64
SC76C/C	1 kit	0,65	340	35	76	50	64	64

HEXAGONAL INSULATOR

Hexagonal insulator H= 25,30,35,60,65,70 mm- Thread M6, M8, M10, M12

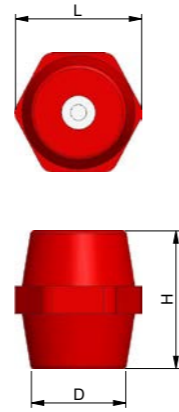

PRODUCT CODE	PACKAGE CONTENT	WEIGHT (KG)	H (MM)	L (MM)	D (MM)	THREAD (M)
BK2827/C	10	0,2	25	22	18	M6
BK3049/C	10	1	30	30	26	M6
BK3551/C	10	0,75	35	32	29	M8
BK3916/C	10	0,97	35	41	35	M8
BK3924/C	10	0,97	35	41	35	M10
BK4054/C	10	1,25	40	41	34	M8
BK4617/C	10	1,4	45	46	38	M8
BK5051/C	10	1	50	36	30	M8
BK5549/C	10	1,62	50	50	40	M10
BK6067/C	10	2,7	60	55	43	M10
BK6554/C	10	2,5	65	41	32	M8
BK6562/C	10	2,7	65	41	32	M10
BK7057/C	10	4	70	60	48	M8
BK7065/C	10	4	70	60	48	M10
BK7073/C	10	4	70	60	48	M12

SPACING PILLARS

Spacing pillars H=30,40,60 mm- Thread M6, M8

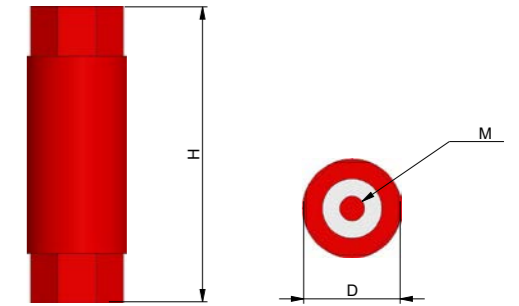

PRODUCT CODE	PACKAGE CONTENT	WEIGHT (KG)	H (MM)	L (MM)	D (MM)	THREAD (M)
BK2307/C	10	0,5	30	18	20	M6
BK3306/C	10	0,5	30	27	30	M6
BK3308/C	10	0,5	30	27	30	M8
BK4408/C	10	1,1	40	36	40	M8
BK2606/C	10	0,4	60	18	20	M6
BK3606/C	10	0,94	60	27	30	M6
BK3608/C	10	0,94	60	27	30	M8